

BATTERY CHANGE STANDARD

STANDARD

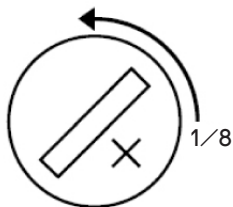

All models except skin, touch, fun

SKIN

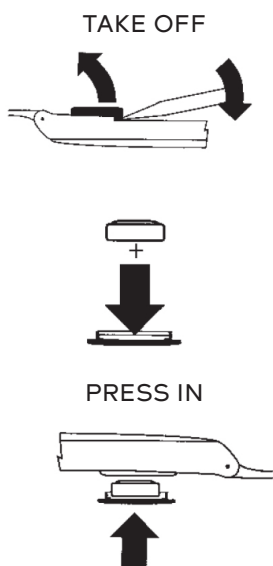

Open carefully the battery cover with a thin screwdriver. Press the battery and cover unit from underneath firmly back to the watch case.

TOUCH / FUN SCUBA

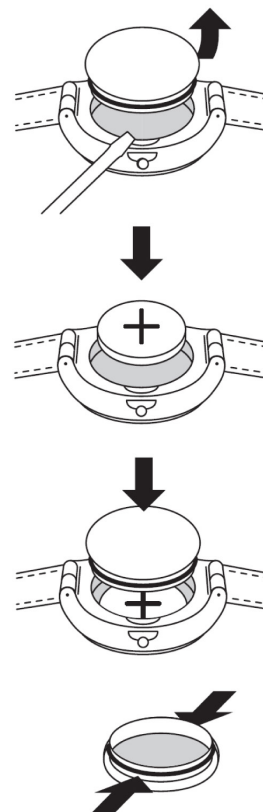

1. Open carefully the plastic cover with a thin screwdriver.
2. Replace the battery, plus (+) side up.
3. Press the plastic cover firmly back on its position (small click).

Note: Check carefully that the rubber gasket is on its correct position and is not harmed.

BATTERY LIST

<u>Collection</u>	<u>Renata Designation</u>	<u>Ø t x Ht (mm)</u>	<u>Battery voltage (V)</u>
Autoquartz	MT 920	9.50 x 2.10	Accu
Beat Alu	CR1632	16.0 x 3.20	3.00
Beat Alu Medium	CR1632	16.0 x 3.20	3.00
Beat Alumini	350	11.60 x 3.60	1.55
Beat Plastic + Beat Plastic Access	CR1632	16.0 x 3.20	3.00
Flik Flak	377	6.80 x 2.60	1.55
Flik Flak Scuba	377	6.80 x 2.60	1.55
Fun Scuba/ Boarder	CR2025	20.0 x 2.50	3.00
Gent	390	11.60 x 3.10	1.55
Gent Access / Gent Snowpass	390	11.60 x 3.10	1.55
Gent Loomi/ Gent Loomi Touch	389	11.60 x 3.10	1.55
Gent X-Large	390	11.60 x 3.10	1.55
Irony Big Inox Alu 1	394 397 377	9.50 x 3.60 7.90 x 2.60 6.80 x 2.60	1.55 1.55 1.55
Irony Big Loomi (Alu)	380	9.50 x 3.60	1.55
Irony Lady Lady Inox/Alu	377	6.80 x 2.60	1.55
Irony Medium Inox/Alu 2	329 397 377	7.90 x 3.10 7.90 x 2.60 6.80 x 2.60	1.55 1.55 1.55
Irony Nabab 3	397 377	7.90 x 2.60 6.80 x 2.60	1.55 1.55
Irony New Big	377	6.80 x 2.60	1.55
Irony Big Classic	377	9.50 x 3.60	1.55
Irony X-Lite Big	377	11.40 x 0.90	1.55
Irony Petite Seconde	394	9.50 x 3.60	1.55
Irony Scuba 200 Inox/Alu	397	7.90 x 2.60	1.55
Irony Scuba Inox/Alu	394	9.50 x 3.60	1.55
Irony Scub Loomi Alu	380	9.50 x 3.60	1.55
Irony Sqare Lady	377	6.80 x 2.60	1.55
Jelly in Jelly + J in J Access + Puzzle Motion	377	6.80 x 2.60	1.55
Lady	329	7.90 x 3.10	1.55
Musicall	390	11.60 x 3.10	1.55
New Gent	390	11.60 x 3.10	1.55
Pop Access	329	7.90 x 3.10	1.55

BATTERY LIST

<u>Collection</u>	<u>Renata Designation</u>	<u>Ø t x Ht (mm)</u>	<u>Battery voltage (V)</u>
Pop/Pop Midi	329	7.90 x 3.10	1.55
Pop-Up	390	11.60 x 3.10	1.55
Scuba + Scuba Access + Scuba Snowpass	390	11.60 x 3.10	1.55
Scuba Loomi	389	11.60 x 3.10	1.55
Skin	317	5.80 x 1.60	1.55
Skin Beat	373	9.50 x 1.60	1.55
Solar	GC 1120	11.0 x 2.0	Gold Cap
Square 3/5 cm ²	377	6.80 x 2.60	1.55
Stop	390	11.60 x 3.10	1.55
Swatch Touch	CR1632	16.0 x 3.20	3.00
Touch Alarm/ Game/ Bi-Timer	CR2025	20.0 x 2.50	3.00
Turnover	377	6.80 x 2.60	1.55



IMPORTANT: The manufacturer's warranty does not cover the SWATCH watch handled by non-authorized persons.

BATTERY CHANGE CHRONO

ALL MODELS

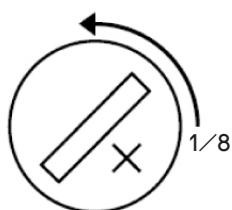

When replacing the battery, be careful not to damage the (+) terminal which is on the side. The (-) terminal is at the bottom.

BATTERY LIST

Collection	Renata Designation	Ø t x Ht (mm)	Battery voltage (V)
Aquachrono	394	9.50 x 3.60	1.55
Chrono	394	9.50 x 3.60	1.55
Chrono Alarme	394	9.50 x 3.60	1.55
Chrono Plastic	394	9.50 x 3.60	1.55
Irony Chrono Inox/Alu	394	9.50 x 3.60	1.55
Irony New Chrono	394	9.50 x 3.60	1.55
X-Lite Chrono	394	13.20 x 1.45	1.55
Irony Diaphane Chrono/Chrono Navigator	394	9.50 x 3.60	1.55
Irony Medium Chrono Inox/Alu	394	9.50 x 3.60	1.55
Irony Retrograde	394	9.50 x 3.60	1.55
Irony Scuba 200 Chrono	394	9.50 x 3.60	1.55
Irony Scuba 200 Chrono Loomi Alu	380	9.50 x 3.60	1.55
Irony THE Chrono	394	9.50 x 3.60	1.55
Skin Chrono	377	6.80 x 2.60	1.55
Square Chrono	394	9.50 x 3.60	1.55



IMPORTANT: The manufacturer's warranty does not cover the SWATCH watch handled by non-authorized persons.